

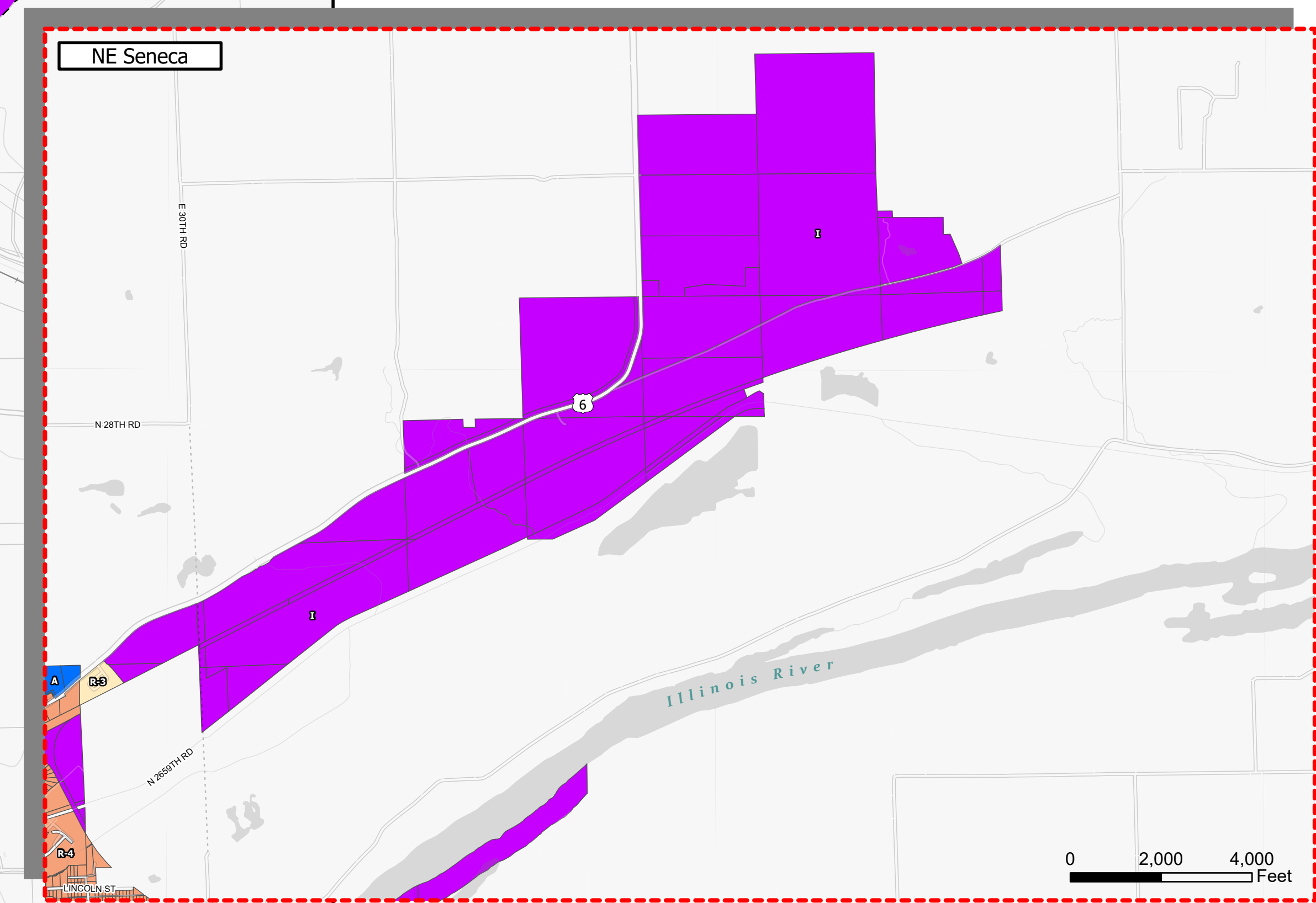

VILLAGE OF SENECA 2024 ZONING MAP

- Legend**
- A - Agricultural Areas & Conservation Open Space District
 - B-1 - Business District
 - B-2 - Service & Wholesale District/Commercial District
 - B-3 - Business Park
 - I - Industrial District
 - R-1 - High Density Residential Multi-Family (5,000 sq.ft. to 7,000 sq.ft. lot)
 - R-2 - High Density Residential Duplex/Mixed (5,000 sq.ft. to 7,000 sq.ft. lot)
 - R-3 - High Density Residential Traile Park/Mobile Home
 - R-4 - Traditional Residential (5,000 sq.ft. to 7,000 sq.ft. lot)
 - R-5 - Medium Density Residential (7,000 sq.ft. to 14,520 sq.ft. lot)
 - R-6 - Low Density Residential (1/3 acre to 5 acre lot)
 - R-7 - Rural Countryside Residential (5 acres or greater)
 - RF - Riverfront District

See NE Seneca Inset Map



0 2,000 4,000 Feet

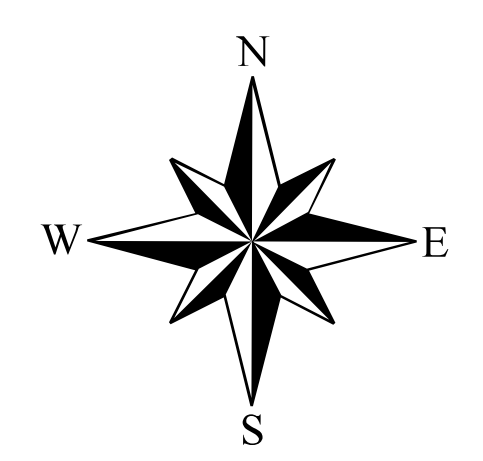

Approved by Village Board on 3/5/2024

0 0.2 0.4 Mile

PUBLISHED BY AUTHORITY OF THE VILLAGE BOARD OF THE VILLAGE OF SENECA, ILLINOIS 61360
Parcel boundaries are to be used only as a reference and may change without notice. True property boundaries are shown in official legal descriptions and plats on file with the LaSalle and Grundy County Recorder of Deeds.